

<b>MODEL</b>	<b>275i</b>	<b>550i</b>	<b>550</b>
Cable fitted	3m	3m	10m
Voltage	230V	230V	230V
Hertz	50Hz	50Hz	50Hz
Watts	4W	7W	7W
Safety Rating	IP68 CE	IP68 CE	IP68 CE
Maximum Depth	1m	1m	1m
Maximum Lift	50cm / 1'7"	100cm / 3'3"	100cm / 3'3"

### Technical Specification and Performance

<b>MODEL</b>	<b>275i</b>	<b>550i</b>	<b>550</b>
Lift in cm	275lph	200lph	0cm
Flow rates lph	185lph	300lph	550lph
Flow rates lph	185lph	300lph	550lph
Flow rates lph	185lph	300lph	550lph
Flow rates lph	185lph	300lph	550lph

**Pump performance / flow chart** (Flow is given as optimum rate)

## 3. GETTING TO KNOW YOUR MINIPOND FEATURE PUMP

### 1. CONTENTS

<b>Getting to know your pump</b> .....	<b>2</b>
Parts descriptions/spares codes - with exploded diagram .....	2
Technical specifications .....	3
Pump performance flow / chart .....	3
<b>Installation</b> .....	<b>4</b>
Electrical Installation .....	4
Pump connection and adjustment .....	4
<b>Maintenance and cleaning</b> .....	<b>5</b>
Cleaning .....	5
Routine maintenance .....	5
Winter storage .....	5
<b>Troubleshooting</b> .....	<b>6</b>
Faults and problems procedure .....	6
<b>Guarantee</b> .....	<b>7</b>



## THE POND MASTERS GUIDE TO MINIPOND WATER FEATURE PUMP 275i/550i/500

Congratulations on buying a Blagdon  
Minipond water feature pump.

Minipond feature pumps are high quality pumps designed with advanced technology, to run a wide variety of water features. The compact powerful motors are easy to maintain having a single moving part impeller system.

Please carefully read the following pond master guide, which will enable you to get the best from your feature pump.

### IMPORTANT

Please attach proof of purchase to this manual and file in a safe place.

<b>No.</b>	<b>Part Description</b>	<b>Code</b>
1.	Pump motor	N/A
2.	Pump outlet	N/A
3.	Impeller complete	1041454
4.	Impeller cover	1041461
5.	Prefilter cover	1041447
6.	Flow adjuster	1041447
7.	1/2" hose fitting	1041447
8.	3/8" hose fitting	1041430
9.	Rubber sucker	1041430

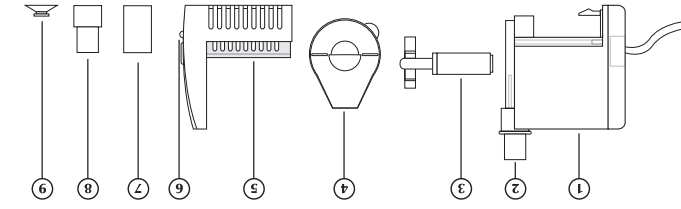

Getting to know your feature pump 550i / 550

<b>No.</b>	<b>Part Description</b>	<b>Code</b>
1.	Pump motor	N/A
2.	Pump outlet	N/A
3.	Impeller complete	1041416
4.	Impeller cover	1041423
5.	Prefilter cover	1041447
6.	Flow adjuster	1041447
7.	1/2" hose fitting	1041447
8.	3/8" hose fitting	1041430
9.	Rubber sucker	1041430

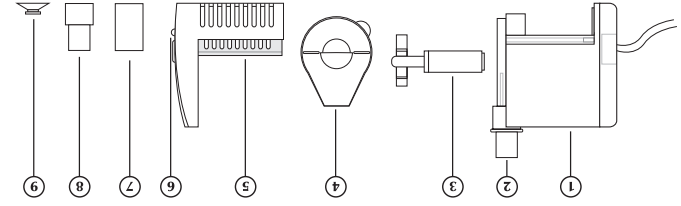

Getting to know your feature pump 275i

## 2. GETTING TO KNOW YOUR MINIPOND FEATURE PUMP



Established over 40 years ago, Blagdon are committed to producing a comprehensive range of high quality, easy to use, pond equipment. An ongoing programme of research and development ensures excellent performance and value for all their customers. This product excellence is demonstrated by Blagdon's award winning range of water gardening equipment. As a result Blagdon's reputation for quality is unrivalled amongst experienced pond gardeners and retailers alike.

Blagdon - The Pond Masters  
The name you can rely on

Interpet  
Dorking, Surrey, RH4 3YX

Leaflet Code: POS 0001



## THE POND MASTERS GUIDE TO MINIPOND WATER FEATURE PUMP 275i/550i/550



## 4. INSTALLATION

### Electrical installation

The power supply must meet the specifications on the product.

#### Outdoor model

The pump is intended to be used with either a weather-proof cable connector or permanently connected to the fixed wiring in the main system other than by means of a plug and socket.

The cores in the supply cable are coloured in accordance with the following code: **Brown = Live, Blue = Neutral, Green/Yellow = Earth.**

The electric cable is permanently connected and sealed in the motor body. If the supply cable is damaged the pump must not be used. Do not use the supply cable to lift the pump as this may cause damage.



#### **WARNING - THIS PUMP MUST BE EARTHED**

A Residual Current Device (RCD), also known as the Residual Current Circuit Breaker (RCCB), with a tripping current not exceeding 30mA must be installed in the supply circuit. A means of disconnection from the supply having a contact separation of at least 3mm in all poles must be incorporated in the fixed wiring.

For permanent installations to the mains supply, it is necessary to conform to the regulations of the local electricity authority and this would include the use of a metal or plastic conduit to protect the cable.

Attention has been drawn to the fact that special rules may exist concerning the installation of your pump (i.e. local building regulations).

Always disconnect the mains electricity supply whilst the equipment is being installed, repaired, maintained or handled. Consult a qualified electrician if in any doubt about wiring this product to the main supply.



**Warning** - The Minipond feature pump is provided with a thermal cut out that temporarily switches off the pump in case of overheating and the pump may automatically restart.

### Locating your feature pump

The feature pump should be located on a firm and level base in the pond / water feature. The pump should be covered with water at all times. Make sure that there is ample cable from the mains supply. Place the pump in the desired location, attach the hose connector that is suited to your water feature.

**Tip:** The larger 1/2" hose fitting will give maximum performance when fitted to the pump.

The flow control can now be adjusted, see adjusting flow control diagram.

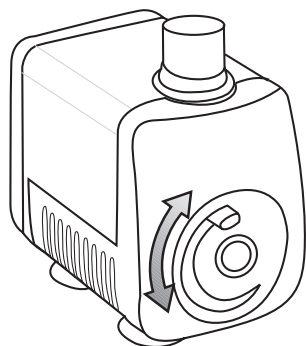

Slide control valve to adjust flow

## 5. MAINTENANCE & CLEANING



**Warning** - Failure to carry out routine maintenance leaving the pump under reduced or no flow conditions (i.e. run dry or blocked prefilter) will result in a shorter pump life and may invalidate the guarantee.

### Cleaning

The use of Blagdon Pond Pump Cleaner will give improved performance and pump life by removing built-up lime scale and waste.

Use before dismantling for easier and cleaner handling.

### Routine maintenance

1. Switch off electricity.
2. Remove the pump from the feature.
3. Follow steps 1, 2 and 3.

#### Step 1

Firmly pull the filter cage from the motor. Wash thoroughly in fresh water.

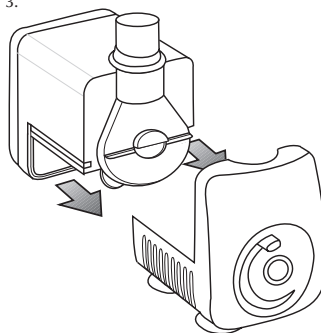

#### Step 2

Push tab to remove impeller cover.

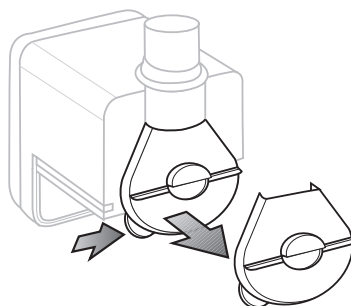

#### Step 3

Remove impeller from the pump motor. Wash thoroughly in fresh water.

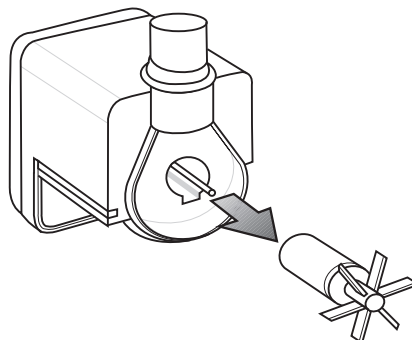

## 5. MAINTENANCE & CLEANING

### Annual Maintenance

Once a year you should service your pump by using Blagdon Pond Pump Cleaner, (this may need to be done more frequently in hard water areas).

Dismantle pump and examine all parts for wear or damage, replacing any parts that show obvious wear and/or damage. (See getting to know your pump for parts/description and replacement parts codes.) Particular care should be taken to examine the cable entry point and the cable; if there is any sign of damage the pump should be discarded.

### Winter Storage

The pump can be run in the pond or feature during the winter but care should be taken to ensure that it is fully immersed and cannot freeze solid. If the pump is not used during the winter, follow annual maintenance procedure and store frost-free in the house or garage until spring.

## 6. TROUBLESHOOTING

### Low flow from the pump

1. Ensure that the pump is fully submerged, and not sucking air due to lack of water in your feature.
2. Follow routine maintenance.
3. Ensure that the pipe work is not blocked, leaking or is laid so that it gets crushed or kinked.
4. Keep the height that water is to be pumped from the water surface (called head) to a minimum. The higher the head the lower the flow rate and the more wear on the pump.
5. Use the largest diameter, smoothest bore hose over the shortest distance and keep hose fittings to a minimum. This removes frictional loss of flow and so increases pump flow rates.

### No flow from the Pump

1. Check that the pump has not run dry due to lack of water.
2. Check power supply is on.
3. Check fuse and wiring (SEE ELECTRICAL INSTALLATION).
4. Follow low flow procedure as above.

If none of the above works contact Interpet (Blagdon) Consumer Advice Department (See Faults problems procedure - section 6).

## 6. TROUBLESHOOTING

### Faults problems procedure

Before returning your Minipond feature pump to your dealer or contacting our Consumer Advice Department, please carry out the following steps. This will solve most problems quickly and easily.

1. Ensure electrical procedure has been followed fully. Check fuse and any cable connectors/switch boxes.  
**NOTE:** If the pump has overheated the thermal overload will temporarily switch off the pump.
2. (a) Follow routine maintenance and check pump.  
(b) Follow troubleshooting guide.  
(c) Follow annual maintenance guide.
3. Return pump to point of purchase for inspection and advice (you may need proof of purchase).

### Consumer Advice contact details

**Interpet (Blagdon) Consumer Advice Department**  
Vincent Lane, Dorking, Surrey RH4 3YX

**Telephone:** 0845 226 7437

(Monday to Friday 10am to 4pm except Bank Holidays - Times may vary)

**Fax:** 01306 876712

**E-mail:** [customercare@interpet.co.uk](mailto:customercare@interpet.co.uk)

## 7. GUARANTEE

This product is guaranteed against defects in material and workmanship for 1 year from the date of purchase, under normal usage.

**The guarantee DOES NOT APPLY in case of improper use,** negligence, lack of maintenance or accidental damage either to the pump or to the impeller or impeller shaft.

If the pump fails due to a manufacturing fault within this period it will be either repaired or replaced free of charge. Liability is limited to replacement of the faulty product only, no other costs will be reimbursed.

This guarantee is not transferable and does not affect your statutory rights. This guarantee does not confer any rights other than those expressly set out above. Excludes the impeller, which may require replacing annually. If any parts need replacing, spares are available from your retailer.